

3401 CARUTH

5 BEDROOMS | 5.5 BATHS | 6,086 SQUARE FEET
\$2,999,000 | 84x170 CORNER LOT | HPISD



PLATINUM HOMES by
MARK MOLTHAN

3401 CARUTH is a transitional home constructed by Platinum Series Homes sitting on a large lot in University Park. The home features Lincoln Windows, open floor plan for entertaining downstairs, study/game room, three-car garage and designer finishes throughout.

Construction completion scheduled for early 2019.



For additional information:
Katie Schortmann | 214.206.7648

www.platinumserieshomes.net | Mark Molthan 214.908.5315

3401 CARUTH

5 BEDROOMS | 5.5 BATHS | 6,086 SQUARE FEET
\$2,999,000 | 84x170 CORNER LOT | HPISD

FIRST FLOOR

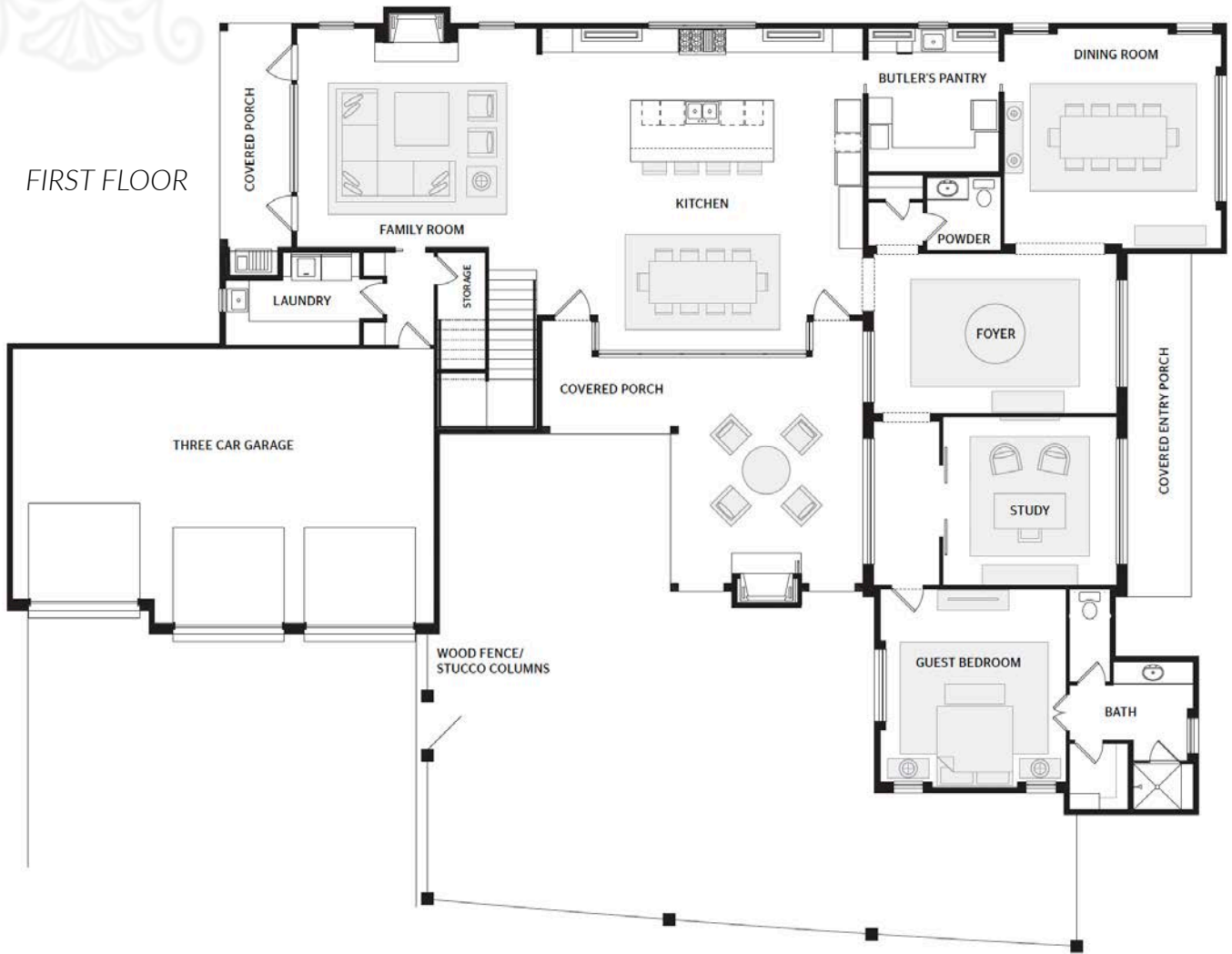

SECOND FLOOR

